



SILVERLIGHT

LA PULSANTIERA A MONTAGGIO SUPERFICIALE
DAL DESIGN ARMONIOSO

- ✓ 4 diverse finiture
- ✓ Testate coordinate
- ✓ Montaggio frontale senza viti in vista



Scotch-brite

Mirror

PVD satinato

PVD lucido

The smooth lines of the endings and the rounded profile of the button panel, make the SILVERLIGHT line a panel with a unique and harmonious look.
 It is made of stainless steel in 4 different finishes: scotch brite, polished mirror, brushed PVD, polished PVD.
 ABS top bottom endings (brushed nickel or gold PVD colors).
 Available in 2 widths and lengths from 227 mm to 1950 mm.



Car

The car panel can also be supplied in a 1950 mm column version.
 Replacement kits are available in both brushed nickel and gold PVD finishes.
 Push-button panel thickness 1,5mm.

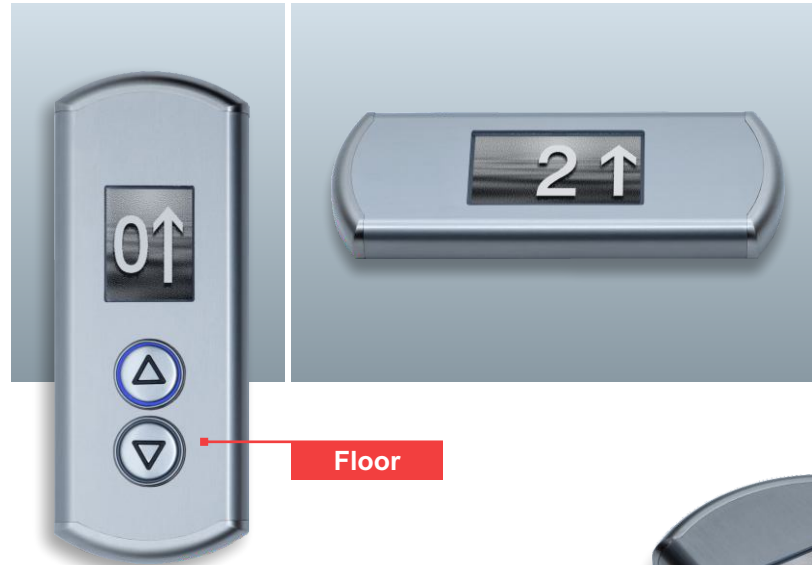

Floor

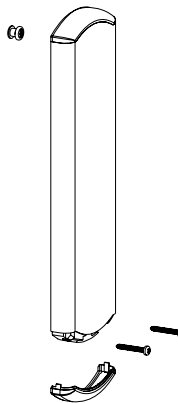

The SILVERLIGHT landing plates are straightforward to install, thanks to an anchor hook and a hidden bottom fixing with no visible screws.
 10 heights available for the 100 mm plates
 Replacement kits are available in both brushed nickel and gold PVD finishes.
 Push-button panels thickness 1,5mm.



L	H													
	227	250	300	357	407	507	607	707	807	907	1000	1107	1207	1950
100	✓	✓	✓	✓	✓	✓	✓	✓	✓	✓				
200					✓	✓	✓	✓	✓	✓	✓	✓	✓	✓

Car column